



Information for the ABMC Scent Work trials at the World Equestrian Center – May 5 and 6 2022

Welcome to the ABMC Scent Work Trials and welcome back to everyone that has previously attended our scent work trials at WEC! We want this to be a wonderful experience for everyone attending. In addition to the information being sent out by our Trial Secretary, Andrea Ferguson, ABMC would like to provide you with some general information about our trials. We are also including a map of the WEC. Our trial this May will be held in Barn N.

Air conditioning

Barn N will be air conditioned for our trials. It will be nice and cool in there, so remember to bring a light jacket if you think you may be cold.

Crating

All crating will be in the horse stalls in Barn N and stalls have been assigned in advance by the club (see below map). Thanks so much to those of you who replied to our emails about crating and to Sara Hurst to heading up this effort. If you have a big issue, please see Trial Chair, Judy Leitzsch or Ginger Rezy at the trial.

We strongly suggest you bring a floor mat to put your crates on, if you have one. The stalls have fans and power (on the outside wall, so bring an extension cord if you will need power). If you have any questions, there will be Club members and workers on-site on the Wednesday afternoon before the trials and of course on trial days, starting at 7:00 am. You can always call me if you need help – 281-650-7683.

The building will be open for set-up on Wednesday, May 4 between the hours of 4 pm to 6 pm only. Please don't come before or after those hours. You will have access to the crating area only, not the rest of the barn.

Potty area -

The potty area will be outside and clearly sign posted. Reminder - please pick up after your dogs and make this a good experience for everyone. Previous exhibitors have been fantastic in this regard, and we thank you in advance for the same experience this May.

Trial hours -

The building will be open from 6:30 am on trial days; judge's briefing will be at 7:30 am and the trial follows.

Parking –

Is right next to Barn N.

Spectators

For your information, we have had some interest from the local community about coming out to watch our dogs work. We want to do our best to accommodate this interest in our sport. Accordingly, we plan to set up a small spectator area for some of our runs, starting after 10 am so the very Novice dogs won't have spectators. AKC encourages spectators, and we are enclosing an excerpt from the AKC Scent work Rules and Regulations about spectators and photography/recording for your information. We will make sure spectators are aware of these regulations. We thank you in advance for your patience and help with this.

Dining at the World Equestrian Center -

There are 8 restaurants located at the World Equestrian Center. Most of them offer take-out food for convenience. Please see the below link for more information.

<https://worldequestriancenter.com/ocala-fl/visit/dining/>

Please don't arrive with take-out food from fast-food restaurants outside of the venue. It should be ok to bring water/treats for your dogs and snacks for yourself should you have special dietary needs. Please try out the on-site dining for breakfast/lunch – there are lots of options and very nice quality at decent prices. I have tried the French bakery in the hotel, the Mexican take-out Restaurant and Ralphs for excellent salads and burgers. We will have bottled water on site for our volunteer workers.

Barn N is a very short walk to Filo's the Mexican restaurant, the Equestrian Hotel for the French bakery, and the Italian restaurant.

General information -

Please know that RVs are not allowed to park during the day in the parking lot. They will need to stay in the RV lot.

There is 24/7 security monitored through cameras and security patrolling the campus.

Staying at the World Equestrian Center -

Please see the below link for accommodation opportunities.

<https://worldequestriancenter.com/ocala-fl/visit/stay/>

Thank you all for attending the ABMC Scent Work trials.

If you have any questions, concerns, comments, please don't hesitate to contact me. Otherwise, enjoy this precious time with you canine companions.

Christine Klockenbrink
Co-Chair, ABMC National Specialty 2022
281-650-7683
christine@belcol.net

Or –

Heather Doucette
Co-Chair, ABMC National Specialty 2022
352-572-8209
teddybearmals@gmail.com

Or –

Judy Leitzsch
Trial Chair ABMC National Specialty Scent work trial
561-707-2620
Frazldmom3@aol.com

Or –

Ginger Rezy
Worker Coordinator ABMC National Specialty Scent work trial
317-370-9571
gingerrezy@gmail.com

Or -

Andrea Fergerson
Trial Secretary
757-343-2954 (after 7 pm)
heyjudetrialsec@gmail.com

Parking Lot

BARN N

SEARCH AREAS

CURTAIN			
TR5			TR4
N75			N74
N76			N73
N77			N72
N59	Yuko Okazato-Kai, Forrest/ Kathy Fornes- Captain		N58
N60	Sarah Keth-Avery, Jimmy Neutron		N57
N61	Rebecca Grinsell-Kash (Thurs)/ Christine Franzek-Anja (Fri)		N56
N62	Carol Ann McElroy-Graeme		N55
N63	Phyllis Lindquist-Curry		N54
CURTAIN			
N78			N71
N79			N70
N80			N69
TR11			TR10
N64	Jane Smith-Star (Fri)		N53
N65	Linda Sue Purkey-Loll (Fri)		N52
N66	Jennifer Gerdes-Romeo, Jipsi		N51
N67	Rita Friedman- G2		N50
N68			N49
N41	Debra Clair-Lex (Fri)/Linda Hartshorn-Echo, Ryder (Fri)	Sara Anderson-Tycho (Thurs)/Lisa Halpin-Ball (Fri)	N40
N42	Karen Childers-Sallor	S. Terri Giannetti-Deacon	N39
N43	Carol Happel-Lilly	Heather Doucette-Tristan and Nala (Committee)	N38
N44	DO NOT USE	Lauren Walsh (Judge)- Raleigh, Cash	N37
N45	DO NOT USE	Judith Lustig-Rogue	N36
N46	Shelley Carpenter-Murfee	Sandy Craft-Stryker, Flint	N35
N47	Alice Hartman-Sara (Fri)	Christina Granatier-Patton	N34
N48	Carolyn Kaiser-Kaden/ Jency Jordan - Scorch (Fri)	Susan Kirkpatrick-Blast	N33
TR9			TR8
N23	Melanie Philpot-Dobby (WL Thurs, In on Fri)	Sally Hensen-Feather, MacLeod (Fri)/ Susan Trotto-Smoaki	N22
N24	Carlene Carlson-Halas	Ashlee Gandeas-Dazzle/Traci Rinoldo-Trixie	N21
N25	Joy Daniels-Phoenix Carol Ahearn-Lila Moon, Lupa	Cindy Deak-Amp, Nott (Thurs)/ Donna Killiam-Kane (Fri)	N20
N26	Lisa Knock-Alvi	Sharon Everson-Ref/Connie Adams-Katie	N19
N27	Christine Klockenbrink-Saxe and Dixie/Nadia Innes-Tex (Committee)	Andrea Ferguson (Sec)-Rebel, Cherry, Riot	N18
N28	Connor Wooten-Lynrd	Ginger Rezy- Bru, Ready (Volunteer Coordinator)	N17
N29	Claudia Bailey-Jewel, Diamond	Connie Telesco-Boscarelli/Judi Tintera-Balley	N16
N30	Jared Redfield-Charley/Linda Redfield- Luka	Jill Hurst- Emmie (Fri)	N15
N31	Bonnie Craig- Olive	Tamara Aunapu-Daisy	N14
N32		Priscilla Coughlin-Loli	N13
TR2			TR1
N7	Bobbie Kurivial-Squall/Deb Belles-Chevy/Diane Keedy Ticker	Donna Siwicki-Blue (Thurs)/Suzi Metz-Trooper (Fri)	N6
N8	Betsy Reiney-Tuck (Fri), WL Kite Fri	Stacy Valentine-Belle	N5
N9	Judy Leitzsch (Chair)- Bodie, Winnie	Amy Eisenstadt-Ople/Rosey Feeley-Heidi	N4
N10	Beth Jernigan-Scuppers, Schooner	Sue Harris-Ella	N3
N11	Patricia Lovell-Piper /Barbara Layton-Josi	Reserved ABMC - Scott Svabos	N2
N12	Jennifer Balocco-Jayo/ Debra McKnight-GeenaME	Reserved ABMC - Jeanine Daugherty	N1
TR7			TR6

To Arena 3

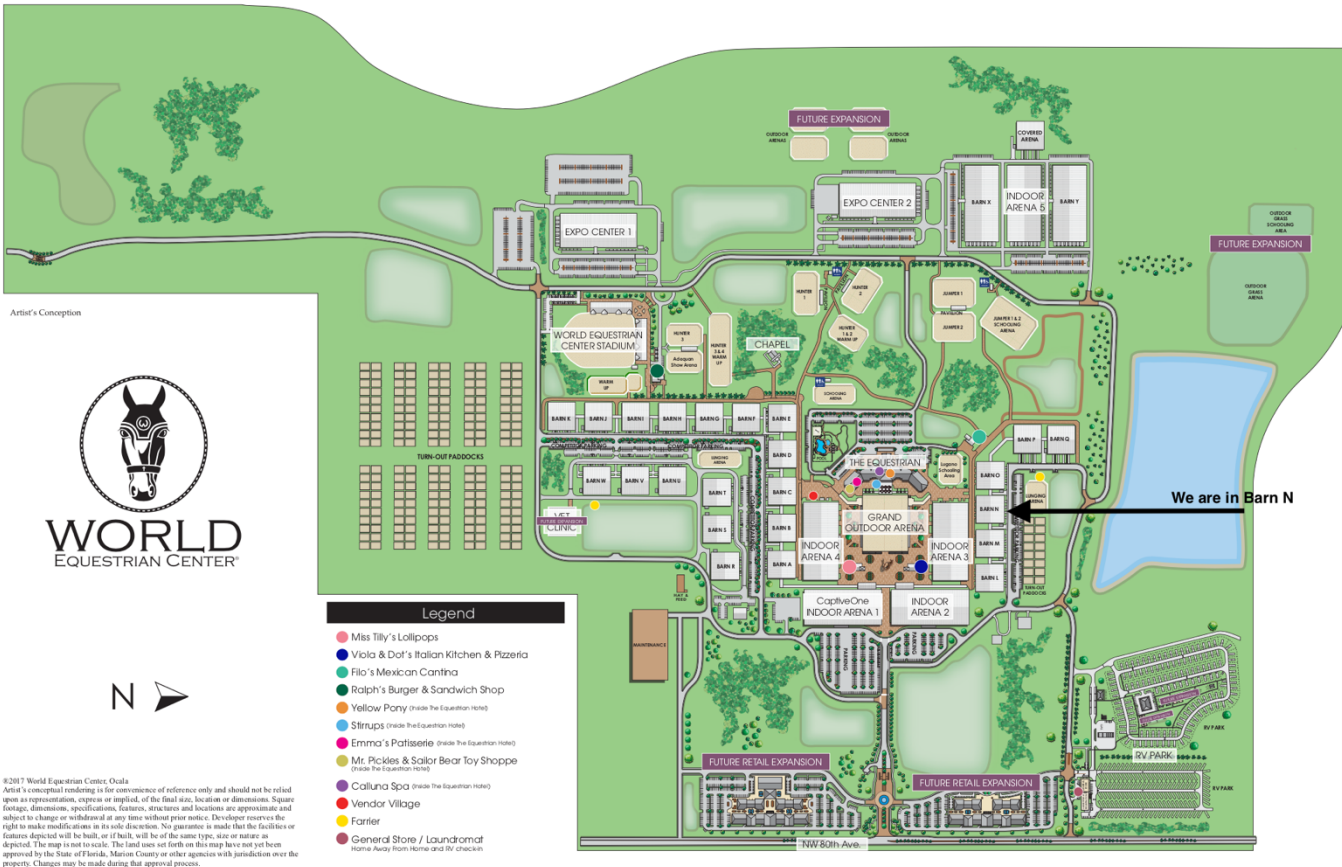

Section 36. Spectators and Double Handling. Spectators are encouraged, however, no one outside the search area may assist the handler or disclose the location of the hide. Spectators should take care to remain neutral in order to not provide clues to the handler. Judges may excuse or re-run exhibitors whose dogs they reasonably believe have benefited from double handling. Spectators who intentionally or unintentionally give aid to a team may be asked to leave the spectator area by the judge. Handlers may not watch other exhibitors from their class prior to their turn, except in the case of Handler Discrimination classes.

Section 37. Spectator Area. See Chapter 3, Section 32 for details on the spectator area. Any person not handling a dog in the current class, or any person who has already completed their run in that class, may choose to watch searches from the spectator area. Spectators are absolutely forbidden from discussing details of the search with handlers who have yet to run. Even seemingly innocuous details can inadvertently aid a team's performance. The basic rule is this: *If you would not know the information but for being in the spectator area, you cannot discuss the information.*

Section 38. Photography and Recording Devices. With the permission of the dog's owner and handler, spectators are encouraged to photo and video dogs and handlers while they search, however under no circumstances may they share this with any handler competing in the same class who has not yet run. Handlers are not allowed to take video while handling a dog, except that wearable cameras such as the "Go Pro" are permitted to be worn by dogs or handlers. These videos are for the enjoyment of those who cannot be present to watch the team search, and for the handler to have a keepsake of their experience.